

WHEEL HOUSE LEVEL PLAN
1/21-1/22

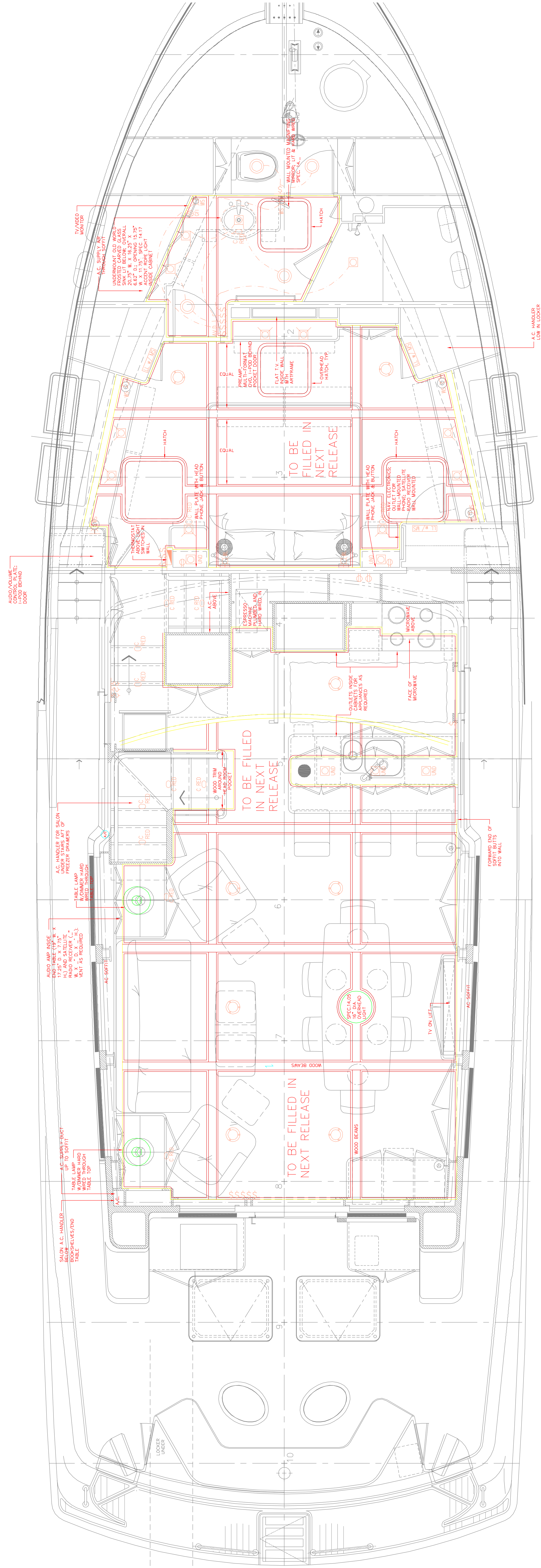

MAIN LEVEL PLAN
1/21-1/22

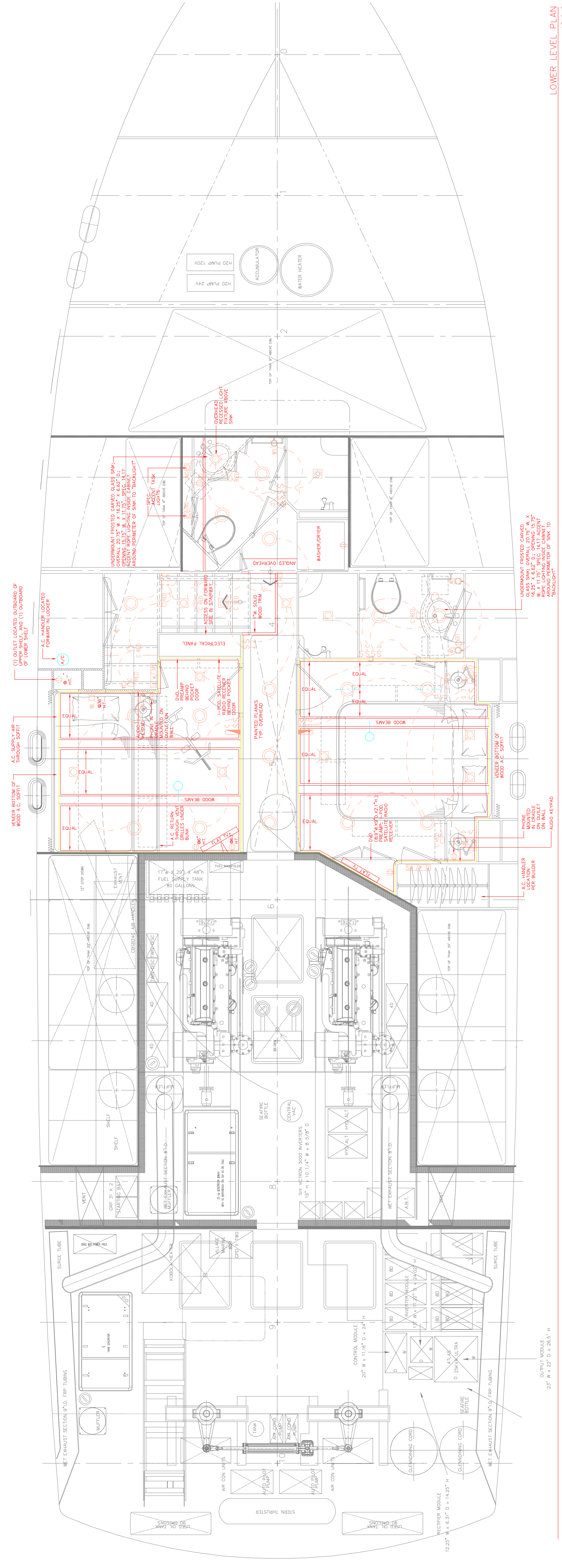

LOWER LEVEL PLAN
1/21-1/22

ELECTRICAL LEGEND

	OVERHEAD RECESSED LIGHT W/SCREWS, SPEC 14.01		GOOSE NECK CHART LIGHT, SPEC 14.14		SWITCH FOR LOCKER DOORS
	OVERHEAD RECESSED LIGHT W/OUT SCREWS, SPEC 14.02		COURTESY STEP LIGHTS (RED), SPEC 14.14		GRAPHER EYE LIGHTING SWITCH
	EXTERIOR RECESSED LIGHT, SPEC (PER PAE)		LOCKER LIGHT W/ MICRO SWITCH, SPEC 14.14		VMAR SWITCH
	OVERHEAD RECESSED ADJUST. LT. DEEP, SPEC 14.03		ROPE LIGHT, SPEC 14.14		VMAR 3-WAY SWITCH
	OVERHEAD RECESSED ADJUST. LT. SHALLOW, SPEC 14.04		TELEPHONE JACK		VMAR 4-WAY SWITCH
	UNDER CABINET LIGHT, SPEC 14.14		TV CABLE OUTLET		AV SWITCH
	PILOT HOUSE RED RECESSED LIGHT, SPEC 14.14		COMPUTER NETWORK JACK RJ45		VMAR COURTESY LIGHT SWITCH
	SPENNER		FXK OUTLET		VMAR DIMMER SWITCH
	WALL LIGHT 1, SPEC 14.14		VMAR DUPLEX OUTLET		L.E.D. ROPE LIGHT (RED) SWITCH
	WALL LIGHT 2, SPEC 14.14		VMAR SINGLE OUTLET		L.E.D. ROPE LIGHT (WHITE) SWITCH
	WALL SCONCE 1, SPEC 14.14		VMAR GFI OUTLET		SECURITY SWITCH
	WALL SCONCE 2, SPEC 14.14		VMAR DOUBLE NARROW OUTLET		A.V. VOLUME SWITCH
	WALL SCONCE 3, SPEC 14.14		AV OUTLET		GARBAGE DISPOSAL

GENERAL NOTES:
 1. ALL REMOVABLE OVERHEAD PANELS TO BE MAINTAINED OR VINYL WARE WITH 1/4" RADIUS ON ALL EDGES APPROX. MOOK UP.
 2. FINAL OVERHEAD PANEL BWM DUE TO SOFFIT SIZES TBD PER CONDITIONING OUTLET.
 3. BUILDER RESPONSIBLE FOR DETERMINING NUMBER OF OUTLETS REQUIRED FOR EQUIPMENT.
 4. THERMOSTATS TO BE LOCATED CLOSELY.
 5. DO NOT LOCATE RECESSED HALOGEN OVERHEAD LIGHTS ABOVE DOORS IN LATCHED OPEN POSITION.
 6. PLEASE REVIEW ALL APPLIANCE SPECIFICATIONS AND REQUIREMENT PRIOR TO CONSTRUCTION.
 7. FABRICATOR TO CONSULT WITH AUDIO AND VIDEO SPECIFICATIONS DETERMINE PLACEMENT AND PONE REQUIREMENTS PRIOR TO INSTALLATION OF OUTLETS AND FABRICATION OF CABINETRY.
 8. ANY DEVIATION OR SUBSTITUTE FROM INFORMATION PROVIDED HERE SHALL BE ALLOWED WITH THE PRIOR APPROVAL OF ARDED DESIGN, INC.
 9. UNLESS OTHERWISE NOTED SWI SHALL BE LOCATED WITH CENTER AT 42.5" (TBD.) ABOVE FINISHED FLOOR.
 10. BUILDER TO MESSUP, REVIEW APPROVE STAIRS CONFIGURATIONS.

NOTES:
 THIS DRAWING IS INTENDED TO CC STRIKE DESIGN INTENT ONLY. BUT CREATE CONSTRUCTION SHOP DRA BASED ON DIMENSIONS. INFORMATION PROVIDED BY PACIFIC ASIAN ENTE PLEASE VERIFY ACTUAL CONDITION DIMENSIONS PRIOR TO FABRICATION. INSTALLATION OF ANY INTERIOR COMPONENTS, NOTIFY ARDED DESIGN ANY SUBSTANTIVE VARIANCE FROM CONDITIONS SHOWN.

THIS ARDED DESIGN ELECTRONIC DRAWING IS INTENDED FOR THE M. BRIS WILLIAMS YACHT ONLY. IT IS PROPERTY OF ARDED DESIGN, INC. NOT BE REPRODUCED OR IN ANY FORM WITHOUT THE EXPRESS WRITTEN CONSENT OF ARDED DESIGN, INC.

BUILDER IS RESPONSIBLE FOR AIR CONDITIONING EQUIPMENT AND OUTLET LOCATIONS, AND DIMENSIONS PRIOR TO FABRICATING ENTERTAINMENT CENTERS.

BUILDER TO HAVE APPLIANCES PLACING OUT GALLEY CABINETS.